

QUICK INSTALLATION GUIDE

Three-phase ESS Inverter 5K/6K/8K/10K

1 PACKING LIST

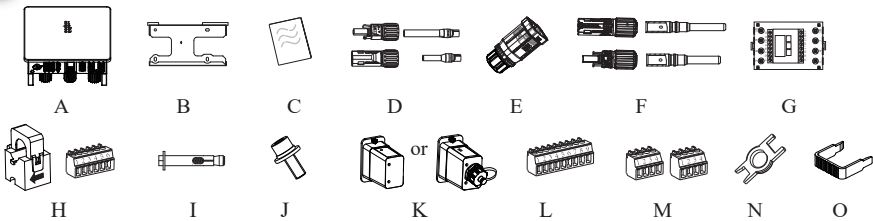

A	Inverter	H	CT pack (3pcs CT+1pcs 6-Pin terminal)
B	Mounting bracket	I	M10 Expansion screws
C	File package	J	M6 Security screw
D	PV terminal connector group (PV+/PV-)	K	WIFI/LAN module (optional)
E	GRID/BACKUP connector	L	9-Pin terminal
F	Battery terminal connector group (BAT+/BAT-)	M	4-Pin terminal
G	Meter (optional)	N	Removal tool for PV/battery connector
		O	Removal tool for GRID/BACKUP connector

2 LOCATION

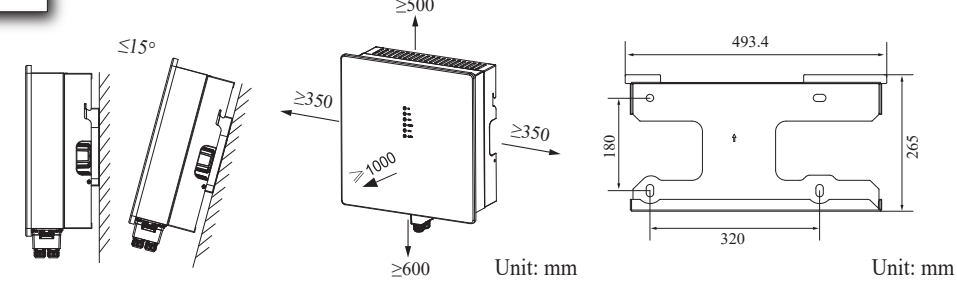

3 INSTALLATION

- 1. The walls must be fireproof and non-flammable materials, otherwise there is a fire risk.
- 2. Before drilling holes, check whether there are electric power pipes or other pipes buried in the walls to avoid risks.

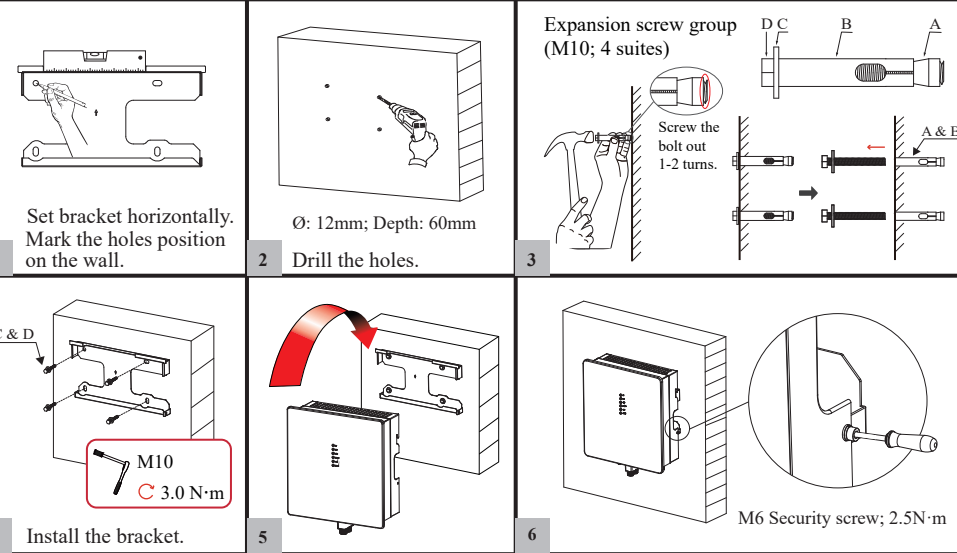

4 GROUNDING

- Ensure that inverter and all cables to be installed are completely powered off during whole installation and connection. Otherwise, fatal injury can occur due to the high voltage.

Items	Remark
Screw	M4 × 12mm; 1.2 N·m
OT Terminal	OT6-4
Yellow green lines	S (Yellow green lines) ≥ S (PE line of AC cable) S is the cross-sectional area.

5 WIRING SYSTEM Non-parallel connection mode

- Ensure that the inverter and all cables to be installed have been completely powered off during the whole process of installation and connection. Otherwise, high voltage may result in fatal injury.

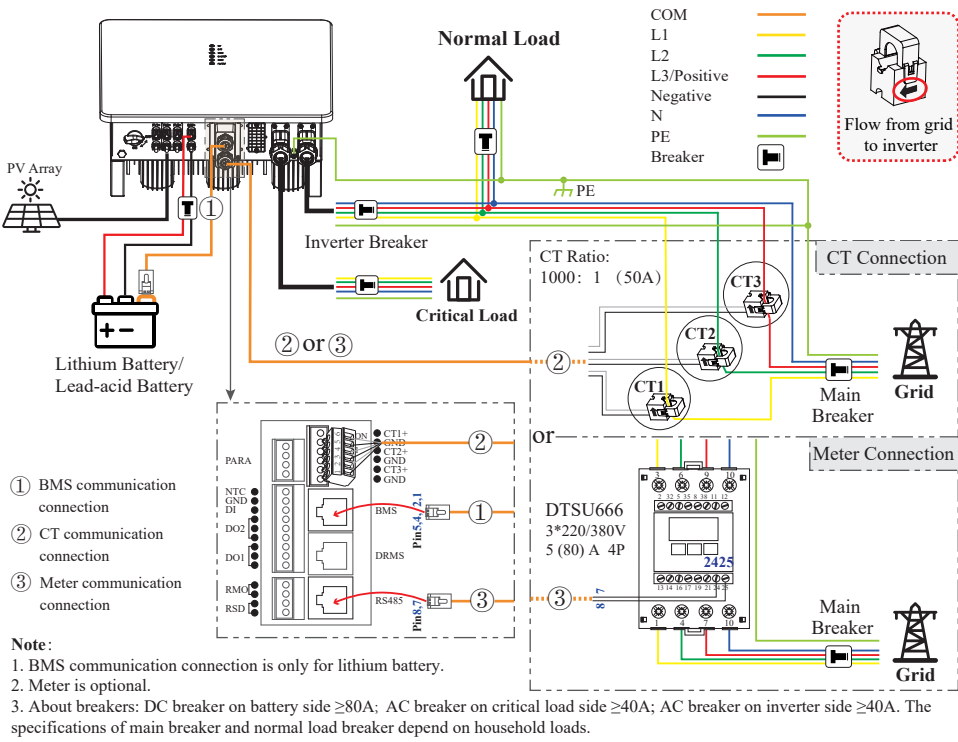

6 WIRING SYSTEM Parallel connection mode - Scheme A (N=2)

- Ensure that the inverter and all cables to be installed have been completely powered off during the whole process of installation and connection. Otherwise, high voltage may result in fatal injury.

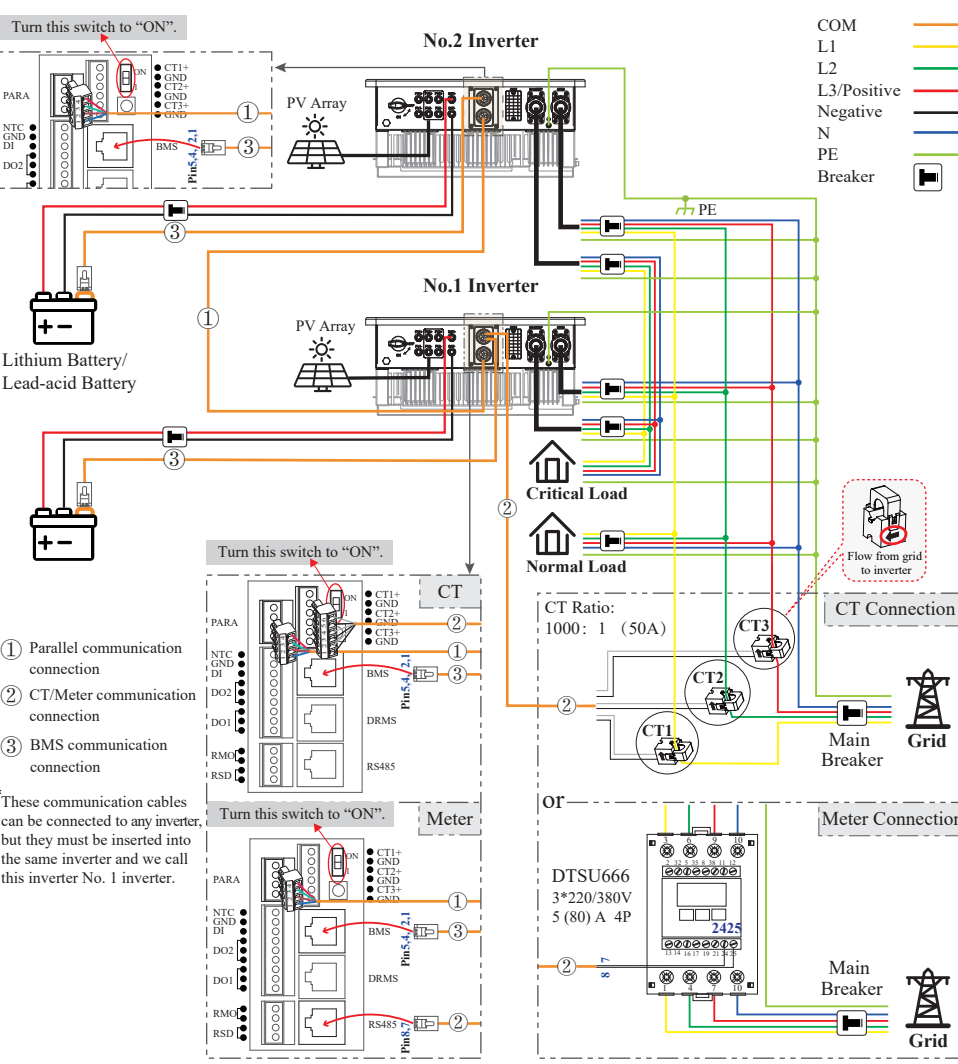

7 WIRING SYSTEM Parallel connection mode - Scheme B (2 < N ≤ 9)

- Ensure that the inverter and all cables to be installed have been completely powered off during the whole process of installation and connection. Otherwise, high voltage may result in fatal injury.

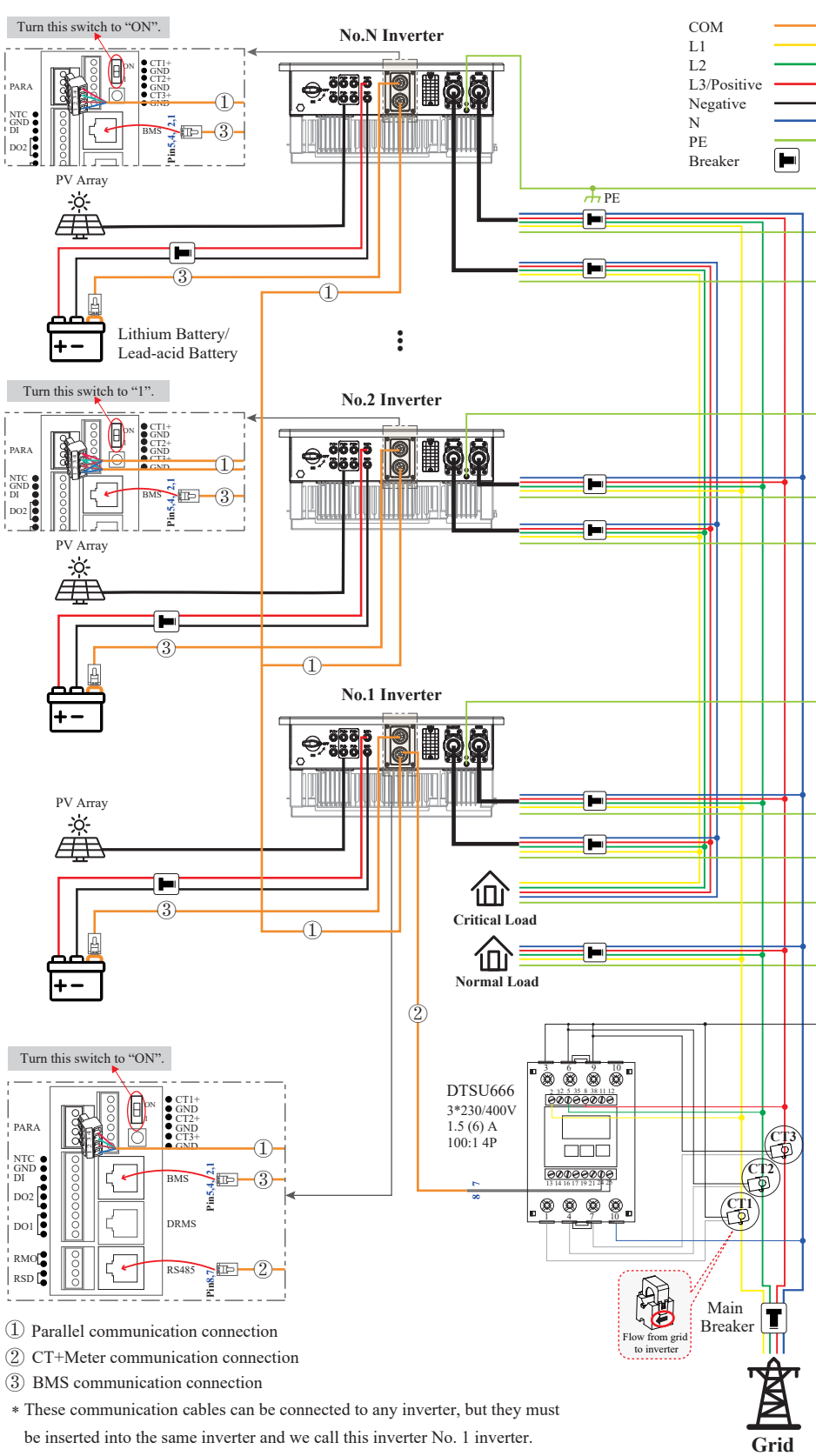

- Note for parallel connection modes — Scheme A and B:
- 1. BMS communication connection is only for lithium battery.
  - 2. It is necessary to turn the matched resistance switch of No. 1 inverter and No. N inverter to "ON" and turn others to "1" in parallel connection mode. (Only for Scheme B)
  - 3. With parallel connection mode, it is necessary to connect APP to one of inverters and then go to [Console > Hybrid Setting> Other > Parallel mode](#) page to enable **Parallel mode** on APP. Setting/modifying the parameter requires logging into an administrator account.
  - 4. About breakers: DC breaker on battery side ≥80A; AC breaker on critical load side ≥40A; AC breaker on inverter side ≥40A. The specifications of main breaker and normal load breaker depend on household loads.

